

The Y Studio on 2/F is particularly spacious and versatile: it measures 26.3m long, 12.4m wide and 5.6m tall, and can fully accommodate different stage set-ups or scene settings. The hall can be transformed into a Studio theatre that holds minimum 256 persons, or a fully opened space (without seating) that holds about 500 persons, or can be used for rehearsals, exhibitions, etc. at any time as well. The size of the venue can be adjusted by using operable partition walls.



### **Directions**

MTR: Hong Kong Line, Chai Wan station

Bus: The Kowloon Motor Bus Co. (1933) Ltd.:  
106, 106P, 118, 606, 606X, 802, N118

Citybus and New World First Bus

8H, 8S, 8X, 19, 81, 81A, 82, 82S, 106, 314, 682, 694, 698R, 780,  
802, A12, N118

Nearby Public Car Parks:

Hing Wah Estate Public Car Parks.



### **Parking**

Permit required

### **General Setup**

Youth Square – Y Studio operates on a “bare-walls” touring policy. That is, all equipment is normally setup and struck within the booking period. Hirers are reminded to allow sufficient preparation time to hang theatre masking, rig all overhead stage lighting and set up sound. Immediate request apart from Event Requirement Checklist may not be accommodated.

管理及營運 Managed and Operated By

 **新世界設施管理有限公司**  
New World Facilities Management Company Limited

香港柴灣柴灣道 238 號 238 Chai Wan Road, Chai Wan, Hong Kong

電話 Tel: 3721 8888 傳真 Fax: 3721 8889 網頁 Website: [www.youthsquare.hk](http://www.youthsquare.hk), [www.nwfm.com.hk](http://www.nwfm.com.hk)

### **Auditorium**

#### **Mode A (Full stage include Room1,2 and 3)**

Area	326.50m <sup>2</sup>
Dimension	26.35m x 12.40m
House Curtain to Cyclorama	5.60m
Auditorium seating	256 persons
**Stage at Room 3. Exit of Y Studio at Room 1.	

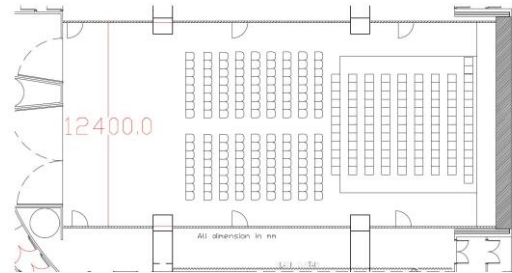

#### **OR**

Auditorium seating (chairs only)	304 persons
-------------------------------------	-------------

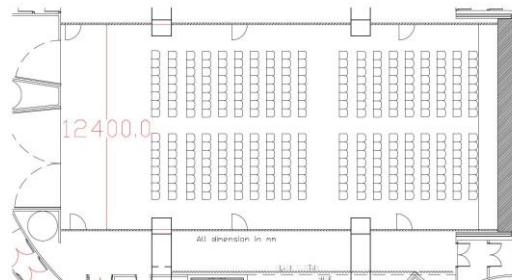

#### **Mode B (2/3 stage include Room1 and 2)**

Area – Room 1 + Room 2	214m <sup>2</sup>
Room 1+2 dimension	17.25m x 12.40m
** Auditorium with 8.4 x 10m (WxD) in Room 1	
** Stage with 7.25 x 12.4m (WxD) in Room 2	

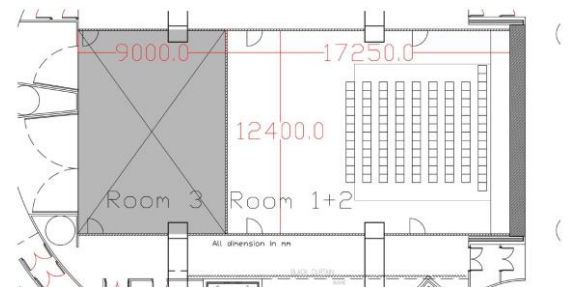

#### **Mode C (Individual stage for Room1, Room2 and Room3)**

Area – Room 1	116 m <sup>2</sup>
Room 1 dimension	9.35m x 12.40m
Area – Room 2	97 m <sup>2</sup>
Room 2 dimension	7.80m x 12.40m
Area – Room 3	112 m <sup>2</sup>
Room 3 dimension	9.00m x 12.40m

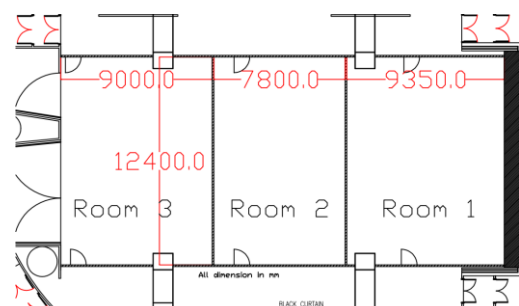

### **Stage Height**

Underside of lighting bridge	5.6m
Underside of mezzanine floor perimeter	2.7m

### **Stage Floor**

Flat Danish wooden floor surface (No nailing direct on stage floor)	400kg/m <sup>2</sup> SWL
--	--------------------------

### **Crossover**

Rear of Black shields from Room 1 to Room3  
Doors on both sides  
Rear of stage and both sides

### **Rigging System (At Room 3 only)**

Hand Winch Bars	6 sets
Capacity	250kg SWL
Distance	0.27m
Length	5.3 to 6.4m
Blue House Curtain Bars	1 pair
Stage Lighting Bars	2 sets
Spare Hand Winch bars	2 sets
(Other bars are obstructed by lighting bars)	
Electric Bars	8 sets
Capacity	500kg SWL
Distance	0.2m
Length (generally)	12.9m
Stage Lighting Bars	3 sets
Spare Bar	1 set
(Other bars are obstructed by lighting bars)	

### **Stage Equipment**

Masking	Leg	2	1.50 x 6.00m (W x H)
Black rear backdrop		1	12.00 x 6.00m
Back Projection Screen (BP)		1	12.00 x 6.00m
(Either BP or backdrop as background)			
White gauze		1	12.00 x 6.00m
Modular Stage Platform			
6x4 ft / 1.8x1.2m (W x L)			16" / 406mm (H) x 6 24" / 609mm (H) x 6

Additional charge incurred if more than 12 platforms

Dance Tiles	Black	5	Additional charge incurred
-------------	-------	---	----------------------------

\*For Dance Performance use only.

\*Please prepare the boards to cover the venue dance tiles or bring your own tiles if the programme include tap dance.

\*Please allow time to lay the tiles during your booking time

Choir Riser	3-tiers	3	Approx. for 36-40 persons
Musician chairs		20	
Music stands		20	
Ensemble stools		4	
Podium		1	

Instrument	Yamaha Upright Piano	1	Additional charge incurred
------------	----------------------	---	----------------------------

JLG Aerial Working Platform		1	
-----------------------------	--	---	--

Operated by competent person & prior approved by venue management only

### **Changing Room**

1 changing room at 2/F

1 changing room at 2M/F

Each room has capacity of 20 persons

管理及營運 Managed and Operated By

 **新世界設施管理有限公司**  
New World Facilities Management Company Limited

香港柴灣柴灣道 238 號 238 Chai Wan Road, Chai Wan, Hong Kong

電話 Tel: 3721 8888 傳真 Fax: 3721 8889 網頁 Website: www.youthsquare.hk, www.nwfm.com.hk

## Lighting Equipment

Dimmers	ETC Sensor 3 dimmer system. A total of 288 nos. of 3kW dimmers. Dimmer room located at 2/f side stage right.
Control Board	ETC ION control panel with 40 faders wing and full back up control facilities, controllable of minimum 6,000 outputs, located in control room at 2m/f.
Houselights	Dimmer controlled. Take-control is available in Lighting Control Room, stage right next to the dimmer room and audience entrance.
Circuits	288 x 3.0kW production lighting circuits, fixed wiring type, are terminated to 15A socket outlets to UK standard and distributed at various locations throughout the stage and lighting bridges.
Additional Power	1 set of 63Amp 3-phase socket, located at Stage Left wall box. The hirer may bring-in electrical equipment and connect to the additional power source at side stage subject to the required electrical works must be conducted by the local registered electrical workers. The hirer shall supply adequate circuit protective devices for your own electrical installation. 13A wall-mounted socket outlets to UK standard are provided on stage.

Profile	168W	ETC	S4 LED series 2 Lustr, 15/30 °	8
	168W	ETC	S4 LED series 2 Lustr, 25/50 °	8
Fresnel	168W	ETC	S4 LED Fresnel Adaptor, 15/50 °	10
Par	63W	Chroma- Q	Color One 100X RGBA LED	8
Cyclorama Wash	400W	Altman	Spectra CYC RGBA LED	4
Follow Spot	575W	Robert Juliat	Buxie MSD 575 HR G22	2
Additional charge incurred				

管理及營運 Managed and Operated By

 **新世界設施管理有限公司**  
New World Facilities Management Company Limited

香港柴灣柴灣道 238 號 238 Chai Wan Road, Chai Wan, Hong Kong

電話 Tel: 3721 8888 傳真 Fax: 3721 8889 網頁 Website: www.youthsquare.hk, www.nwfm.com.hk

Updated on Jun 2019

Gobo holder	B size			15
	B size (for LED Zoom Profile)			10
	A size (for LED Zoom Profile)			10
Smoke machine	1.8KkW	Martin	JEM ZR44 HI-MASS	2
Side Light Tower				6
(Please allow time to set up during your booking time)				
<b>@tower pre-rigged</b>	<b>ETC S4 LED 15/30</b>			<b>3 (Total:18)</b>
	<b>ETC S4 LED Fresnel</b>			<b>1 (Total:6)</b>

**@tower configuration**

<b>ETC S4 LED 15/30</b>
<b>ETC S4 LED Fresnel</b>
<b>ETC S4 LED 15/30</b>
<b>ETC S4 LED 15/30</b>

**Pooled Lighting Equipment List** (For Productions with a Lighting Designer)

**Equipment availability varies according to repair and maintenance, etc. Check with the theatrical manager/supervisor for any changes. FIRST COME FIRST SERVED BASIS ON PRESENTATION OF A COMPLETED LIGHTING PLAN. The set-up and usage of all lighting equipment are subject to the approval of the theatrical manager/supervisor, and has to be setup by appropriate qualified persons.**

Ultra Violet	175W	Wildfire	Vio Stom LED	2
Profile	168W	ETC	S4 LED series 2 Lustr, 15/30 °	10
	168W	ETC	S4 LED series 2 Lustr, 25/50 °	12
Fresnel	168W	ETC	S4 LED Fresnel Adaptor, 15/50 °	20
LED Par	63W	Chroma- Q	Color One 100X	10
Cyclorama Wash	400W	Altman	Spectra CYC	4

管理及營運 Managed and Operated By



香港柴灣柴灣道 238 號 238 Chai Wan Road, Chai Wan, Hong Kong

電話 Tel: 3721 8888 傳真 Fax: 3721 8889 網頁 Website: www.youthsquare.hk, www.nwfm.com.hk

### Sound

Sound System	d&b Yi7p (main PA speaker)	6
	d&b Bi6-SUB (ceiling subwoofers)	2
	d&b E8 (foldback monitor, set on need basis)	2
Main Control Console	DiGiCo SD 9	1
	Fader	24
	Mono/Stereo inputs	48/24
	Mono/Stereo outputs	32/16
CD Audio recorder	Tascam SS-CDR250N	2
CD Audio Player	Tascam CD-6010	2
Reverb Processor	Lexicon PCM92	1
Microphones	Shure beta 58 (Dynamic)	3
	AKG C391B (Condenser)	2
	5 units are free. Additional charge incurred for more than 5 units	
Wireless Microphones	Sennheiser UHF 2000 series wireless mic system	
	Body Pack	: SK2000 8
	Handheld	: SKM2000 8
	Headset	: HSP4 8
<b>Max. 8 units are available</b>		
4 units are free. Additional charge incurred for more than 4 units		

### Communications system

Single channel intercom system for stage, control room and other technical positions

Closed circuit TV system

Show relay and paging system

Production desk can be set at the 2M floor technical gallery outside control room or stage left

### Video Equipment

Blu-Ray player	Pioneer Blu-Ray Disc Player BDP-51FD	1
DVD Player	Yamaha DVD S663	1

管理及營運 Managed and Operated By

 **新世界設施管理有限公司**  
New World Facilities Management Company Limited

香港柴灣柴灣道 238 號 238 Chai Wan Road, Chai Wan, Hong Kong

電話 Tel: 3721 8888 傳真 Fax: 3721 8889 網頁 Website: www.youthsquare.hk, www.nwfm.com.hk

Projector	Panasonic PT-DZ13KE1	1
	(Fixed in 2M floor technical gallery)	
(Additional charge incurred)		

**All required equipment will be setup during the booking sessions; please allow sufficient time for equipment setup before performance or rehearsal.**

**Pooled Sound Equipment List** (For Productions with a Sound Designer)

**Equipment availability varies according to repair and maintenance, etc. Check with the theatrical manager/supervisor for any changes. FIRST COME FIRST SERVED BASIS ON PRESENTATION OF A COMPLETED SOUND DESIGN. The set-up and usage of all sound equipment are subject to the approval of the theatrical manager/supervisor, and has to be setup by appropriate qualified persons.**

**Y Studio Only**

Wireless Microphones	Sennheiser UHF 5200 series wireless mic system	
(Y Studio Only)	Body Pack : SK 5212-II	2
	Handheld : SKM 5200-II	2

**Shared by Y Studio & Y Theatre**

Microphones	PCC 160	4
	AKG 391B (Condenser)	4
	AKG D5 (Dynamic)	1
	AKG D7 (Dynamic)	8
	Shure SM57 (Dynamic)	4
Projectors	Sanyo PLC XU105	2
(Additional charge incurred)		
Projection Screen	Dalite 6 x 8 ft Fast-fold	1
	(Additional charge incurred) Dalite 10.5 x 14 ft Fast-fold screen	1
42" HD Plasma TV		2

管理及營運 Managed and Operated By



香港柴灣柴灣道 238 號 238 Chai Wan Road, Chai Wan, Hong Kong

電話 Tel: 3721 8888 傳真 Fax: 3721 8889 網頁 Website: www.youthsquare.hk, www.nwfm.com.hk